

FRONT VIEW OF SINGLE ARM

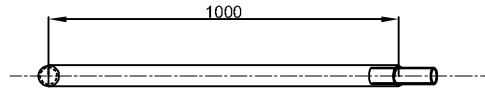

TOP VIEW OF SINGLE ARM

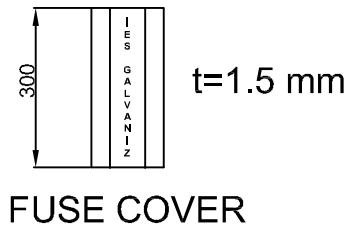
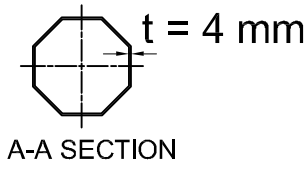

FUSE COVER

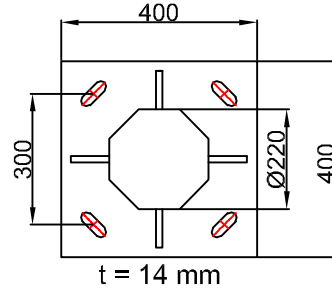

BASE PLATE
C-C SECTION



ANCHOR BOLT
4 M20x720

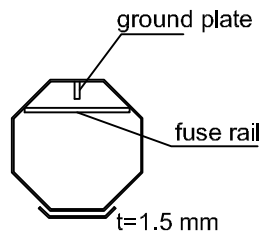

B-B SECTION

Specified dimensions are in "mm". This picture is not scaled. (Belirtilen ölçüler mm'dir. Bu resim ölçekli değildir.)

Project Name: -	
Order / Offer No: -	
Total Weight Tolerance: $\pm 5\%$	
Material Grade: S235	
Welding Standard: TSE EN ISO 3834-2	
Galvanizing Standard: TSE EN ISO 1461	
 İES GALVANİZ www.iesgalvaniz.com.tr info@iesgalvaniz.com.tr	File No: 00000120-01 Revision Date: 30.08.2022 Prepared by: Onur CANATAR
	İES GALVANİZ SAN. ve TİC. A.Ş. Büyüktüysüz Mahallesi E.Ayhan Tosyalı Cad. No:11, Türkmen Beldesi/Toprakkale/OSMANİYE/TÜRKİYE
Page Scale: A4	
Page: 1/1	